



*"Experts in Specialist  
Wheels & Tyres"*

## PRODUCT INFORMATION

# 300 Series Bolt Hole Castor

**Material:** Zinc plated swivel bracket with bolt hole fitting. Wheel with black solid standard rubber tyre on zinc plated pressed steel centre.

|                                |                |
|--------------------------------|----------------|
| <b>Part number:</b>            | 299778M12      |
| <b>Wheel diameter (D):</b>     | 100mm          |
| <b>Tread width (T2):</b>       | 30mm           |
| <b>Tread hardness:</b>         | 85° Shore A    |
| <b>Wheel bearing:</b>          | Roller bearing |
| <b>Top plate diameter (C):</b> | 71mm           |
| <b>Bolt hole (d):</b>          | 12,5mm         |
| <b>Offset (F):</b>             | 38mm           |
| <b>Overall height (H):</b>     | 127mm          |
| <b>Load capacity 3km/h:</b>    | 90kg           |
| <b>Rolling resistance:</b>     | Reasonable     |
| <b>Operating noise:</b>        | Very good      |
| <b>Floor preservation:</b>     | Very good      |

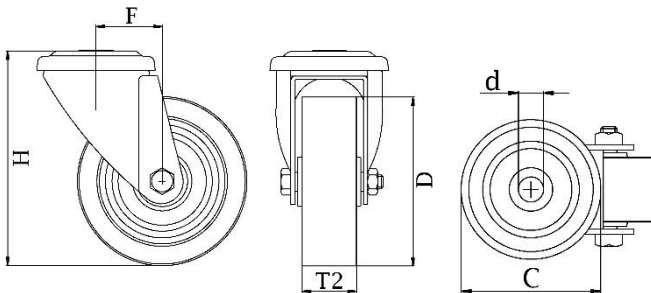

Telephone: (353) 1 452 0482  
Email: [info@parnell.eu](mailto:info@parnell.eu)

[www.parnells.eu](http://www.parnells.eu)

Unit A1 - A2  
Southcity Business Centre  
Whitestown Way  
Tallaght  
Dublin D24 HT95  
Ireland