

## PRODUCT INFORMATION

# 100 Series Bolt Hole Castor

**Material:** Zinc plated swivel bracket with bolt hole fitting. Wheels with grey thermoplastic rubber tread on polypropylene centre.

<b>Part number:</b>	762309
<b>Wheel diameter (D):</b>	50mm
<b>Tread width (T2):</b>	18mm
<b>Tread hardness:</b>	85° Shore A
<b>Wheel bearing:</b>	Plain bearing
<b>Top plate diameter (C):</b>	42mm
<b>Bolt hole (d):</b>	10,5mm
<b>Offset (F):</b>	32mm
<b>Overall height (H):</b>	71mm
<b>Load capacity 3km/h:</b>	70kg
<b>Rolling resistance:</b>	Very good
<b>Operating noise:</b>	Good
<b>Floor preservation:</b>	Good

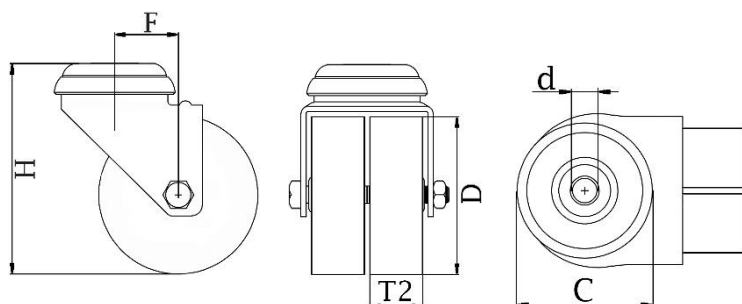

Telephone: (353) 1 452 0482  
Email: [info@parnells.eu](mailto:info@parnells.eu)

[www.parnells.eu](http://www.parnells.eu)

Unit A1 - A2  
Southcity Business Centre  
Whitestown Way  
Tallaght  
Dublin D24 HT95  
Ireland