

PRODUCT INFORMATION

100 Series Top Plate Castor

Material: Zinc plated swivel bracket with top plate fitting. Wheels with grey thermoplastic rubber tread on polypropylene centre.

Part number:	762314
Wheel diameter (D):	75mm
Tread width (T2):	25mm
Tread hardness:	85° Shore A
Wheel bearing:	Plain bearing
Top plate size (AxB):	77x67mm
Fixing hole spacing (axb):	55x48mm
Fixing hole size (d):	8mm
Offset (F):	33mm
Overall height (H):	103mm
Load capacity 3km/h:	100kg
Rolling resistance:	Very good
Operating noise:	Good
Floor preservation:	Good

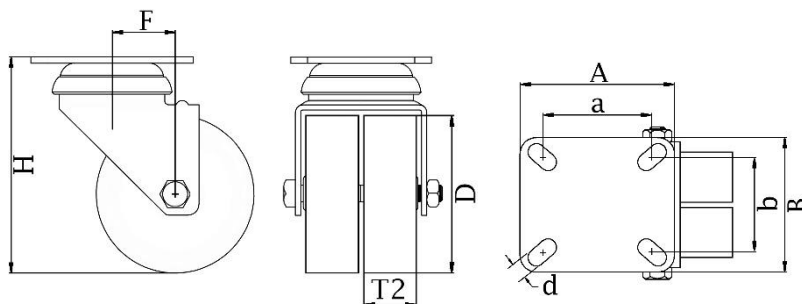

Telephone: (353) 1 452 0482
Email: info@parnells.eu

www.parnells.eu

Unit A1 - A2
Southcity Business Centre
Whitestown Way
Tallaght
Dublin D24 HT95
Ireland